

COMPACT VALVES

Split Body, Floating Ball, Full Bore, Forged Steel, Fire Safety Design, Anti-Static Device, Anti Blow Out Stem, Lever Operated, API 608 Design

CAT-E605-21R0

E605

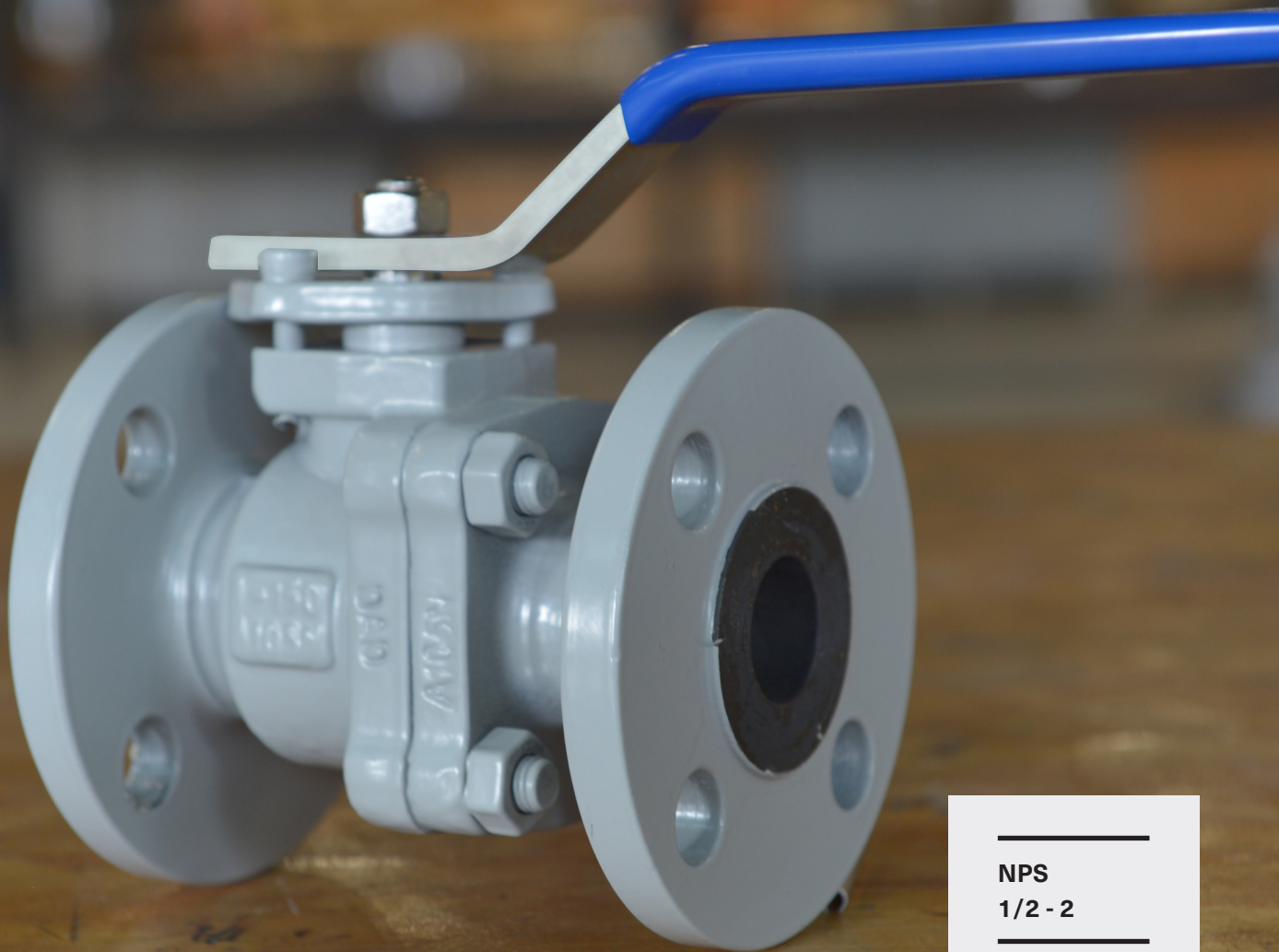

NPS
1/2 - 2

DN
15-50

Class
150 - 2500

E00 SERIES - COMPACT VALVES
COMPACT TYPE SPLIT BODY BALL VALVE

API 608

**Carbon Steel or
 Stainless Steel**

Bolted Bonnet

Floating Ball

Anti Static Device

Full Bore

Features

Vastas compact valves are the types that can be used as drain vent and by-pass elements. These types of valves are mostly forged steel. The body of valve is constructed by a bolt and nut connection of all parts . No sealing elements are used which cause leakage through. When required it can be manufactured from special material according to NACE corrosion standards or temperature class.

Vastas Compact Ball Valves are produced with steel body end fittings are designed as NPT according to ASME B1.20.1. According to customer request Vastas Compact Ball Valves can be produced with flanged ends according to ASME B16.5. In this case FTF Dimension is complying with ASME B16.10 standard.

Compact type split body Ball Valve is ideal for vent, drain, by-pass, takeoff applications. It is often used in pipelines for underground positions.

	STANDARDS
Design	API 608 & ISO 17292 & API 6D
End Connection	(ANSI) B1.20.1, B16.11, B36.10, B16.25, B16.10
End to End	Manufacturer, ANSI B16.5 RF, RTJ
Test	API 598

E00 SERIES - COMPACT VALVES COMPACT TYPE SPLIT BODY BALL VALVE

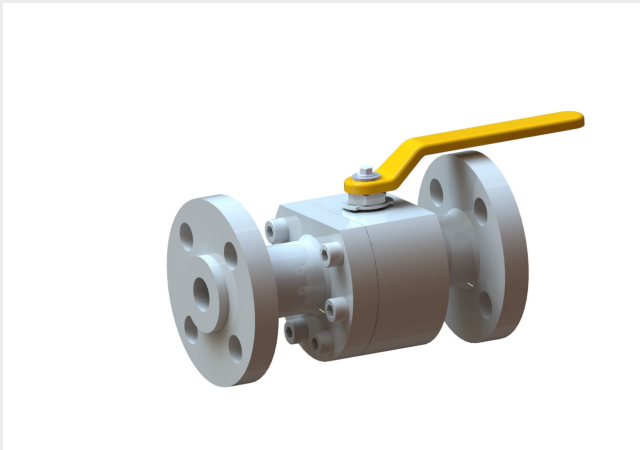

Project Types

NATURAL GAS PIPELINE	CRUDE OIL PIPELINE	LPG STORAGE	LNG STORAGE
FUEL STORAGE	LPG TERMINAL / PLANT	LNG TERMINAL / PLANT	FUEL TERMINAL
NATURAL GAS COMBINED CYCLE PP	REFINERY	RMS	

Applications

Suitable for general application as on/off and isolation valves, not recommended for throttling and/or regulating purposes. They have excellent resistance to earthquake, shocks, vibration, pressure & strokes and can be operated soundly between -29°C to 100°C.

Pressure Rating

The figures at this table are Vastas figures and they indicate pressure class among other specifications.

See page 9 for figure description.

Figure	Size	Class	PRESSURE		
			MPa	Bar	Psig
E605/E615	1/2"-2"	150	2.0	20	285
E605/E625	1/2"-2"	300	5.1	51	740
E605/E635	1/2"-2"	600	10.2	102	1480
E605	1/2"-2"	1500	13.6	136	1975
E605/E645	1/2"-2"	900	15.3	153	2219
E605/E655	1/2"-2"	1500	25.5	255	3705
E605/E665	1/2"-2"	2500	42.5	425	6170

For ASME B16.34 Group 1.1 Material, -29 +38°C

E6 SERIES - COMPACT VALVES

Figure: 605.14

Class: 1500

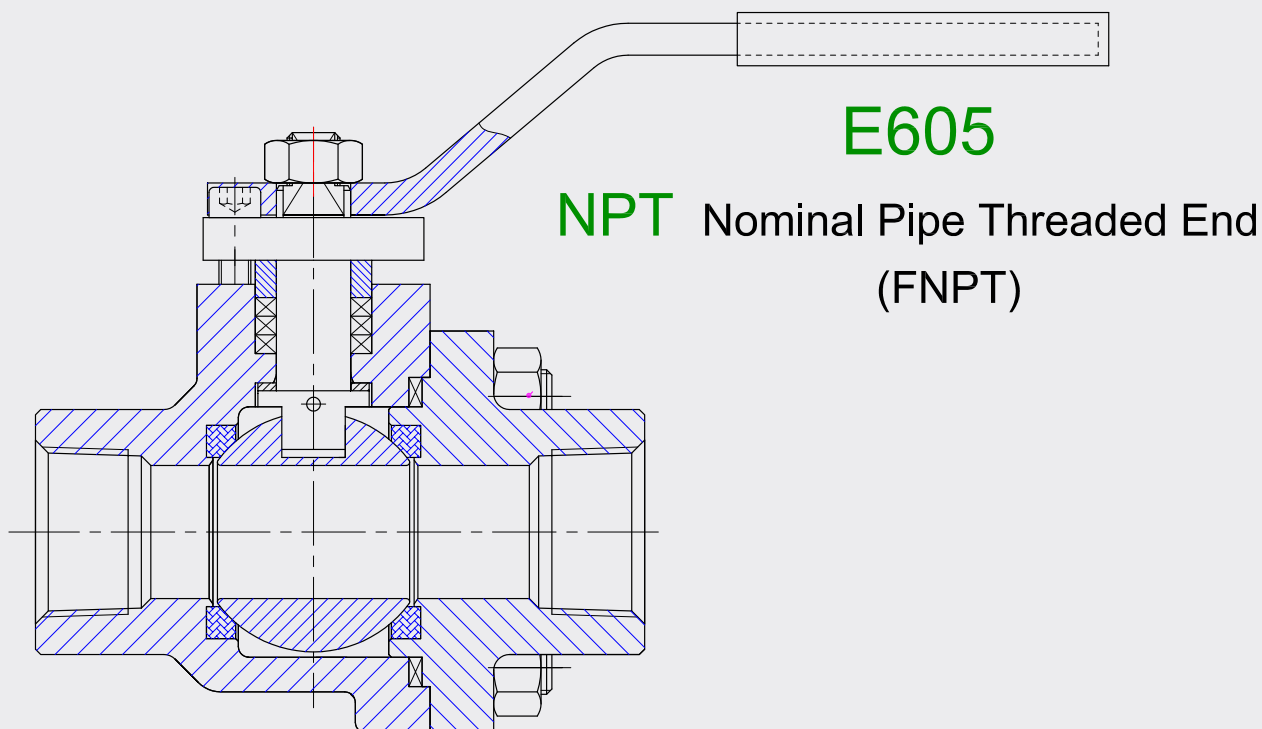

PSSM (Primary Soft Secondary Metal)

The design that provides primary sealing via thermoplastic materials.

Wide variety of materials; PTFE, RPTFE, PCTFE, PEEK, DEVLON, POM-C etc.

Usage in the several environment due to variety of materials

Bi-Directional

Quarter Turn

The on-off process of Vastas compact ball valves are provided with Quarter-Turn movement by a lever. That movement provides rapid and easy operation.

Floating Ball

Ball moves a little with fluid pressure to provide a reliable positive sealing in the flow direction.

Full Bore

Full bore valve design prevents pressure loss.

(ACC. API 608)

Fire Safety Design

Vastas compact ball valves are capable of metal to metal sealing in case of fire. (ACC. API 607)

Anti-Static Device

The stem has an anti-static design which ensures continuous contact of stem-to-ball and stem-to-body. Spark and electric accumulation are prevented by this design.

Coating & Painting

Vastas standard coating application for compact ball valves is 100-150 microns epoxy paint which is resistant to corrosion and moot of chemical and suitable for a wide temperature range. In case of special request other paint systems resistant for high corossive environment, high temprature, various fluids etc. can be applied.

Important Notice

If you receive this catalog as attachment of Vastas offer, please note that, this catalog includes standard product with standard options. The special requirements will be indicated at the offer and the proforma invoice, together with other supporting documents.

Offered options are supported with additional technical documents.

Optional Requirements

Vastas compact ball valves are available with various end connection type. Your connection options are shown in the following section.

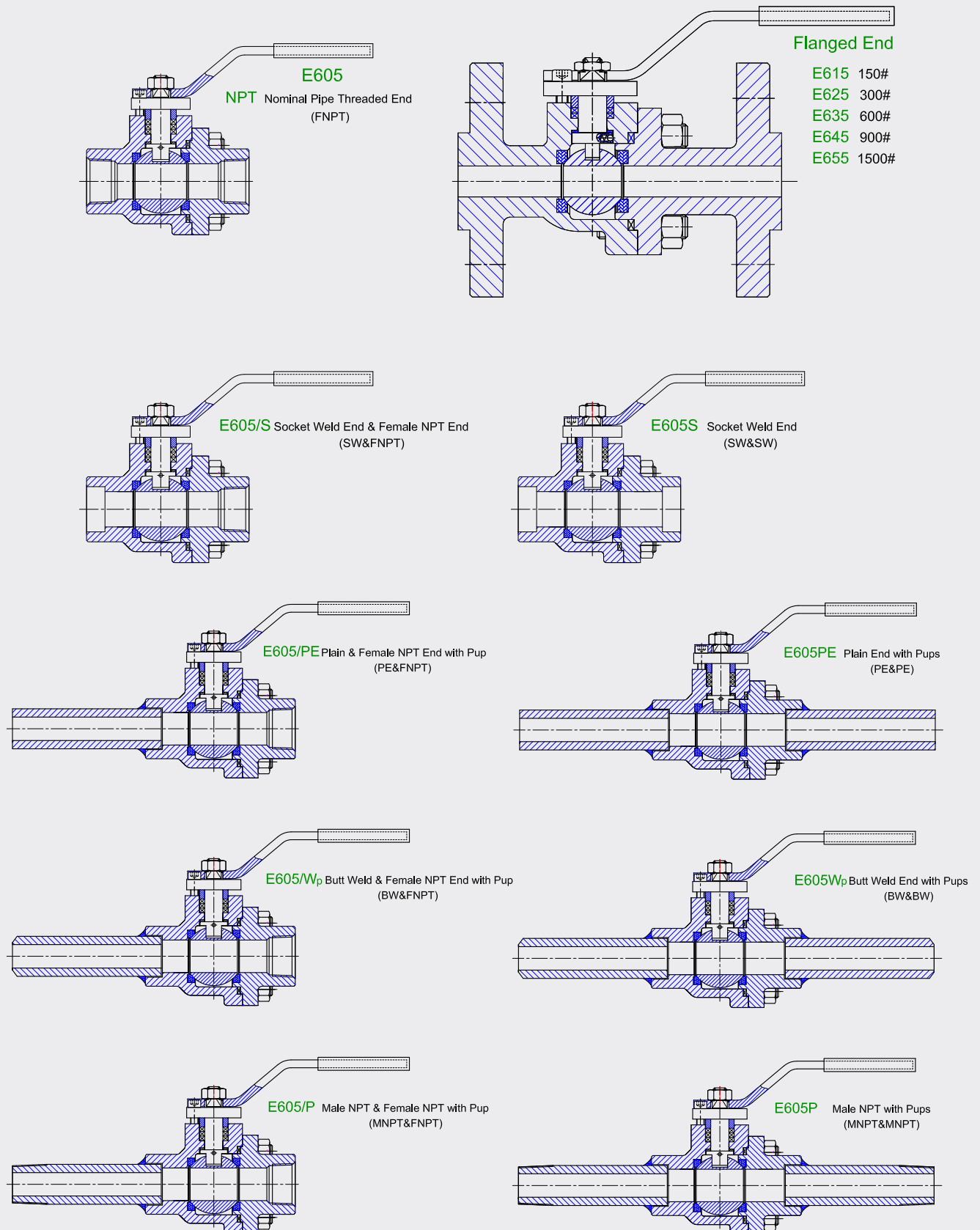

Licence & Approvals

- PED 2014/68/EU
- Safety Integrity Level (SIL) Certified
- Fire Test Certificates
- Corrosion Resistance Cert. as per NACE MR 0175
- Conformity to Ex (Atex)



Spring Return Pneumatic Actuator Operated Ball Valve

Certificates

CERTIFICATE NAME	INSTITUTION	CERTIFICATE No
ATEX-Certificate Conformity to Ex	Energy Petroleum Institute	IEP 17 EX 10013
Safety Integrity Level (SIL) Certified	TUV Rheinland	V 473.02/16
ISO 9001:2015	TUV Rheinland	01 100 032841
ISO 45001:2018	TUV Rheinland	01 133 030066
ISO 14001:2015	TUV Rheinland	01 104 031931
Fire Test on Forged Valves	TUV SUD Turkiye	11-B-00422/01
Fugitive Emission Type Test	TUV Austria Turk	17-IS-1433/02
CE-0408	TUV Austria Services GMBH	ZSTS/SWZE/2190
Certificate of Conformity to Turkish Standards	Turkish Standards Instution	001041-TSE-01/01

Vastas Figure Description

XXX E6X5 X.XX

<p>Size(NPS):</p> <p>0.50 1/2"</p> <p>0.75 3/4"</p> <p>1.00 1"</p> <p>1.50 1 1/2"</p> <p>2.00 2"</p>	
<p>Valve Fig.</p> <p>E605: 1500 Class</p> <p>E615: 150 Class</p> <p>E625: 300 Class</p> <p>E635: 600 Class</p> <p>E645: 900 Class</p> <p>E655: 1500 Class</p> <p>E665: 2500 Class</p>	
<p>End Type:</p> <p>Wp: Butt Weld</p> <p>J: Ring Joint</p> <p>S: Socket Weld</p> <p>P: Pup MNPT&MNPT</p> <p>PE: Plain End</p>	
<p>Body Material:</p> <p>1: A105/LF2</p> <p>2: AISI304</p> <p>4: AISI316</p>	
<p>Trim Material No:</p> <p>4: Stem & Ball SS316, Seat PTFE / POM-C / PEEK / NYLON / PCTFE / RPTFE</p> <p>6: Stem & Ball SS316, Seat FKM / NBR & RPTFE / POM-C</p> <p>7: Stem & Ball SS316, Seat SS316+TCC / CCC / STL</p> <p>8: Stem & Ball SS316, Seat NBR / FKM</p>	

Figure: 605.14

Class: 1500

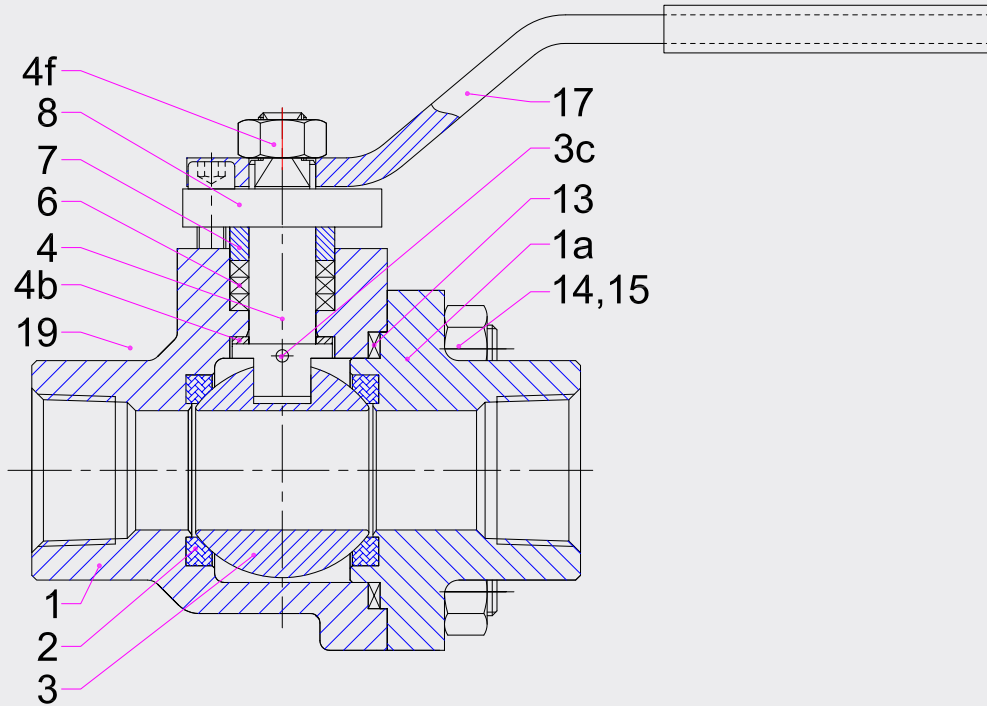

Part List For E605.14

Item	Part Name	Symbol	Material	Item	Part Name	Symbol	Material
1	Body	A105	ASTM A105	6	Packing	GRF	Graphite
1a	Body Part	A105	ASTM A105	7	Gland	316	AISI 316
2	Soft Ring	N/PEEK	Nylon / Polyetheretherketone	8	Gland Flange	A105	ASTM A105
3	Ball	316	ASTM A182 Gr. F316	13	Gasket	SWG	Graphite + 316
3c	Anti Static Device	316	AISI 316	14	Bolt	B7	ASTM A193 Gr. B7
4	Stem	316/17-4	ASTM A182 Gr. F316/17-4PH	15	Nut	2H	ASTM A194 Gr. 2H
4b	Washer	PTFE	Polytetrafluoroethylene	17	Lever	CS	Carbon Steel + PVC
4f	Stem Nut	2H	ASTM A194 Gr. 2H	19	Paint	Ep	Epoxy

Figure: E605.44

Class: 1500

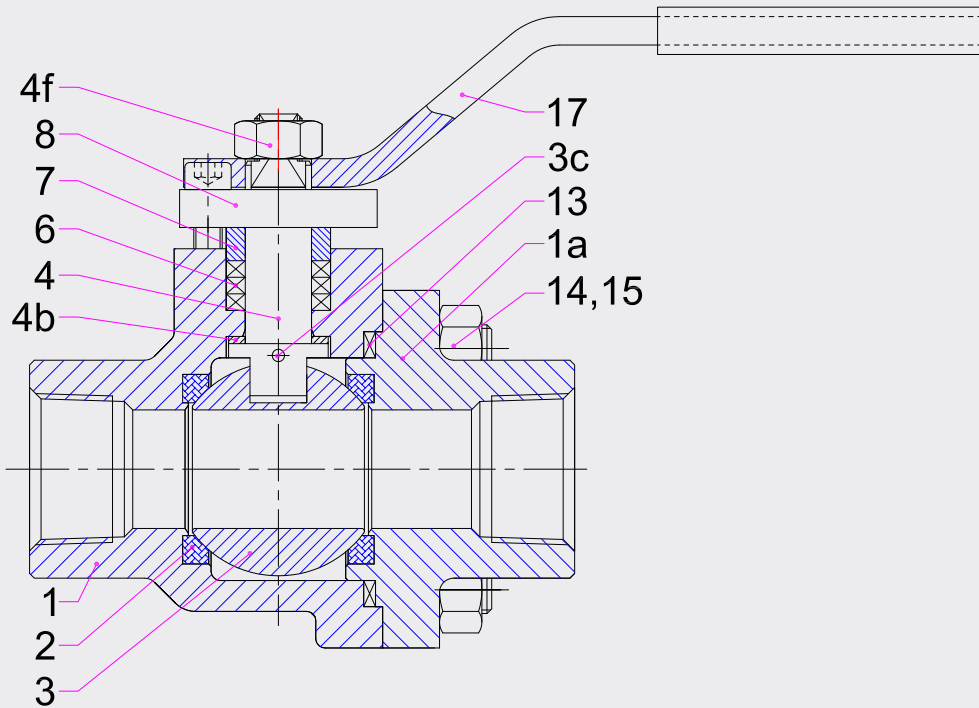

Part List For E605.44

Item	Part Name	Symbol	Material	Item	Part Name	Symbol	Material
1	Body	316	ASTM A182 Gr. F316	4f	Stem Nut	8M	ASTM A194 Gr. 8M
1a	Body Part	316	ASTM A182 Gr. F316	6	Packing	GRF	Graphite
2	Soft Ring	N/PEEK	Nylon / Polyetheretherketone	7	Gland	316	ASTM A182 Gr. F316
3	Ball	316	ASTM A182 Gr. F316	8	Gland Flange	316	ASTM A182 Gr. F316
3c	Anti Static Device	316	AISI 316	13	Gasket	SWG	Graphite + 316
4	Stem	316/17-4	ASTM A182 Gr. F316/17-4PH	14	Bolt	B8M	ASTM A193 Gr. B8M
4b	Washer	PTFE	Polytetrafluoroethylene	15	Nut	8M	ASTM A194 Gr. 8M
				17	Lever	CS	Carbon Steel + PVC

Figure: E605x

X: 800 Class

STANDARDS

Design	API 608 & ISO 17292
Test	API 598
End to End	MANUFACTURER
End Connection	ANSI B1.20.1-NPT

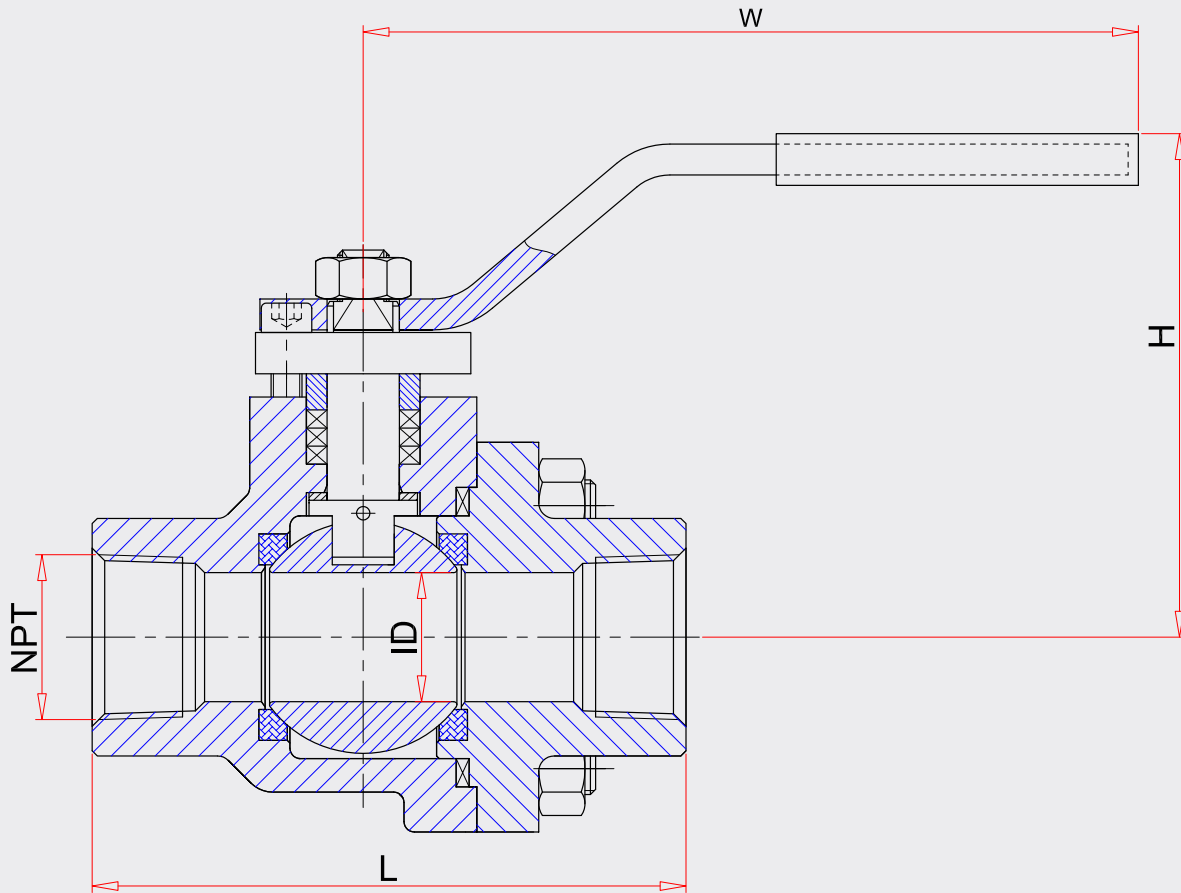

Test Pressure

Class	Shell	Closure
800	205 Barg	80 Barg

Working Pressure (for group 1.1 materials)

-29 +38°C	+100°C Max
136.1 Barg	124.3 Barg

Dimensions & Weight

NPS	ID	L	H	W	Weight
inch	mm	mm	mm	mm	kg
1/2	13	88	75	160	1.45
3/4	20	96	80	160	1.7
1	25	115	99	190	3
1 1/2	38	135	117	260	5.8
2	49	160	138	300	10.5

Figure: E605

Class: 1500

STANDARDS

Design	API 608 & ISO 17292
Test	API 598
End to End	MANUFACTURER
End Connection	ANSI B1.20.1-NPT

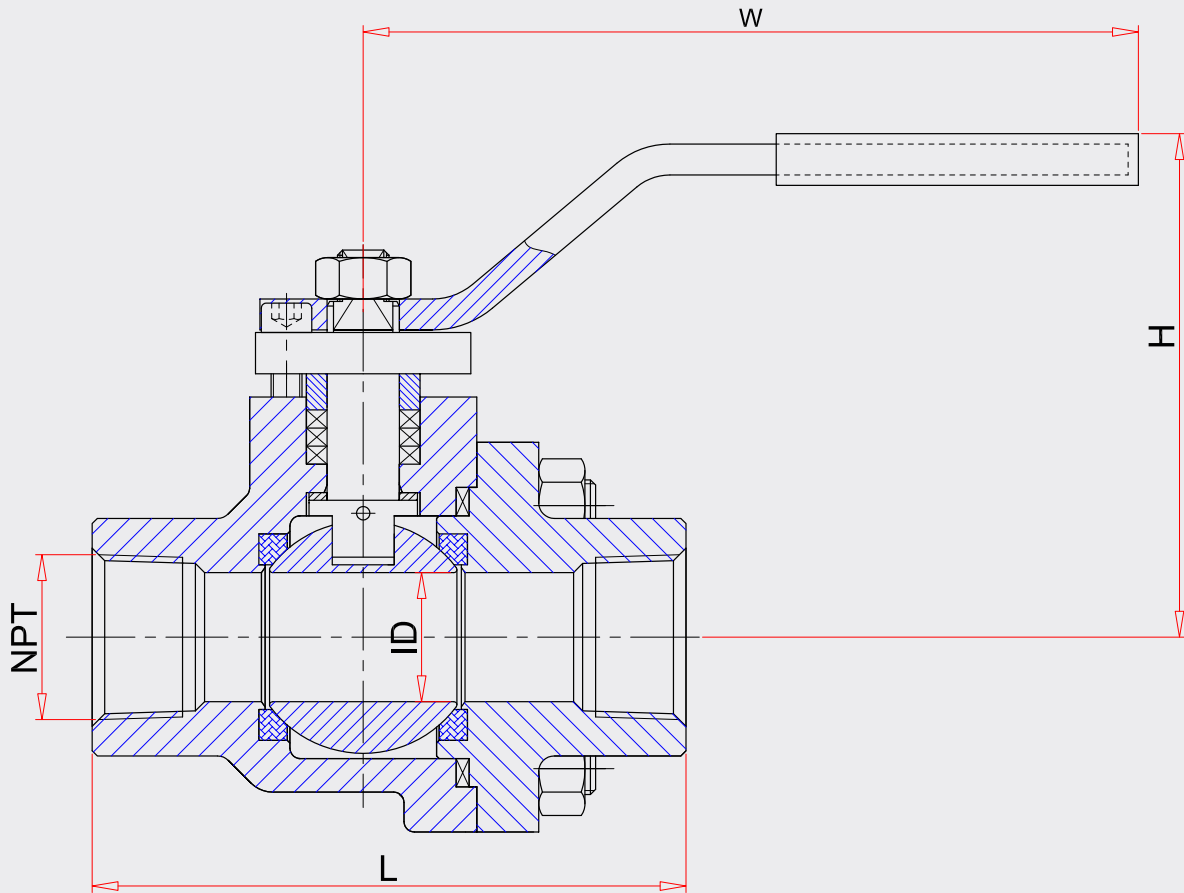

Test Pressure

Class	Shell	Closure
1500	383 Barg	80 Barg

Working Pressure (for group 1.1 materials)

-29 +38°C	+100°C Max
255.3 Barg	233 Barg

Dimensions & Weight

NPS	ID	L	H	W	Weight
inch	mm	mm	mm	mm	kg
1/2	13	100	76.5	160	1.8
3/4	20	115	100	190	3.4
1	25	130	112	260	6
1 1/2	38	160	131	300	10.5
2	49	190	145	300	19

Figure: 615-E655.14
Class: 150-1500

STANDARDS

Design	API 608 & ISO 17292 & API 6D
Test	API 598
End to End	ANSI B16.5 RF
End Connection	ANSI B16.10

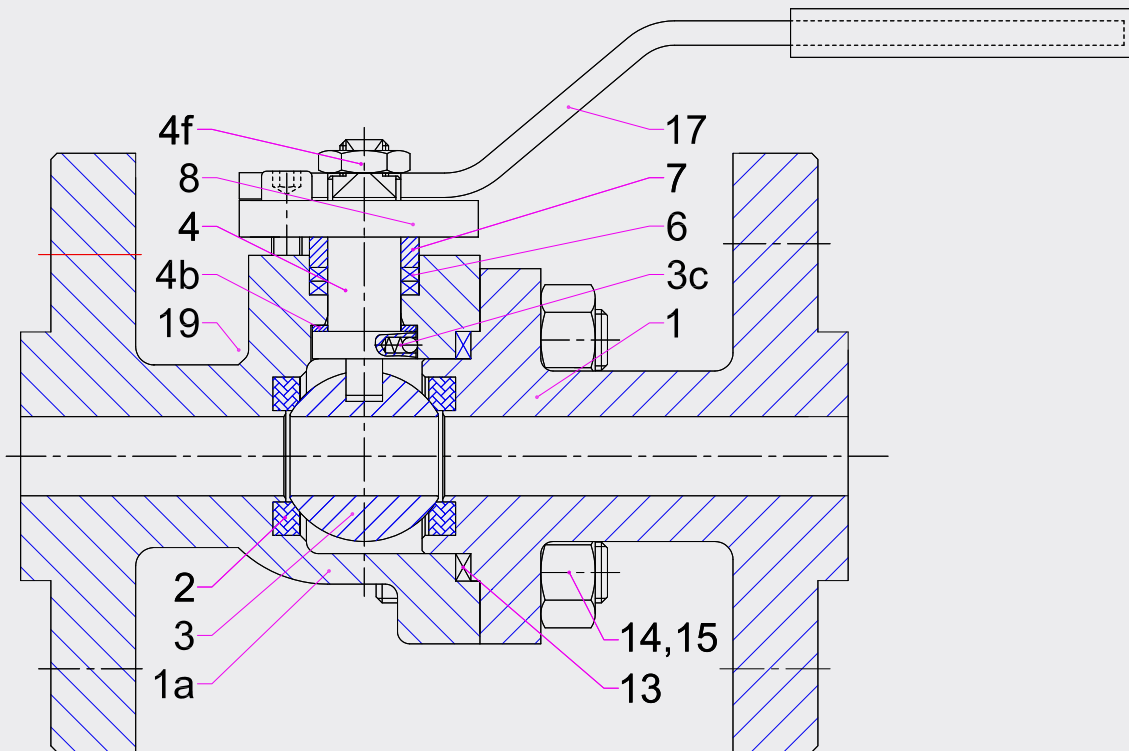

Part List For E615-E655.14

Item	Part Name	Symbol	Material	Item	Part Name	Symbol	Material
1	Body	A105	ASTM A105	6	Packing	GRF	Graphite
1a	Body Part	A105	ASTM A105	7	Gland	316	AISI 316
2	Soft Ring	N/PEEK	Nylon / Polyetheretherketone	8	Gland Flange	A105	ASTM A105
3	Ball	316	ASTM A182 Gr. F316	13	Gasket	SWG	Graphite + 316
3c	Anti Static Device	316	AISI 316	14	Bolt	B7	ASTM A193 Gr. B7
4	Stem	316/17-4	ASTM A182 Gr. F316/17-4PH	15	Nut	2H	ASTM A194 Gr. 2H
4b	Washer	PTFE	Polytetrafluoroethylene	17	Lever	CS	Carbon Steel + PVC
4f	Stem Nut	2H	ASTM A194 Gr. 2H	19	Paint	Ep	Epoxy

Figure: 615-E655.44
Class: 150-1500

STANDARDS	
Design	API 608 & ISO 17292 & API 6D
Test	API 598
End to End	ANSI B16.5 RF
End Connection	ANSI B16.10

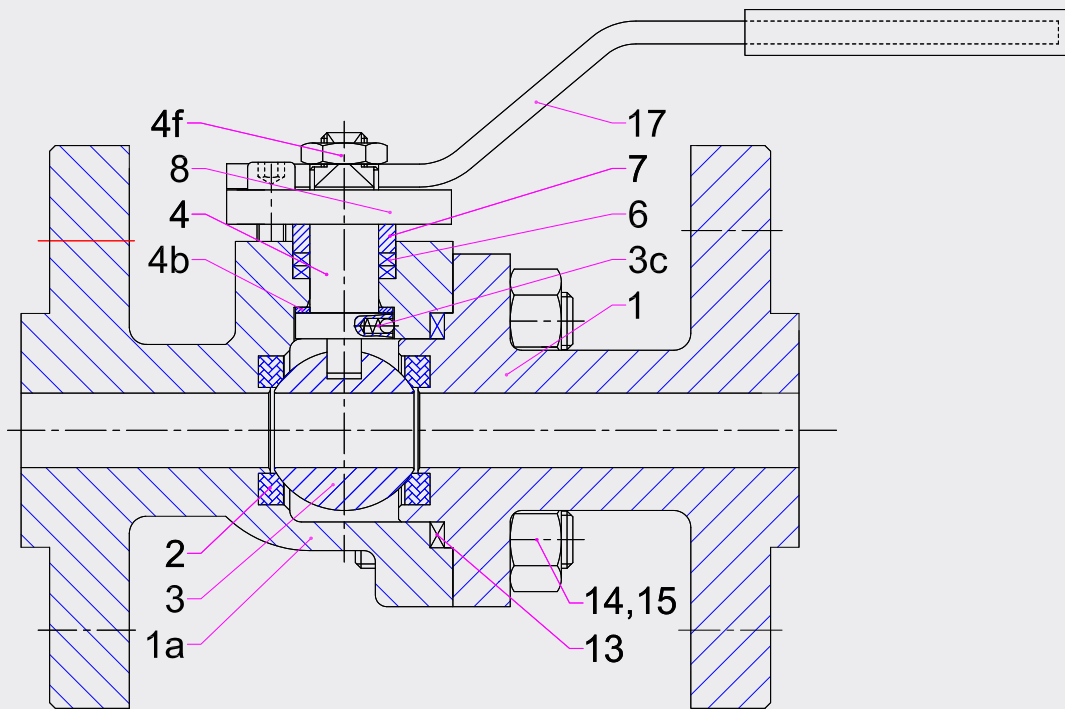

Part List For E615-E655.44

Item	Part Name	Symbol	Material	Item	Part Name	Symbol	Material
1	Body	316	ASTM A182 Gr. F316	4f	Stem Nut	8M	ASTM A194 Gr. 8M
1a	Body Part	316	ASTM A182 Gr. F316	6	Packing	GRF	Graphite
2	Soft Ring	N/PEEK	Nylon / Polyetheretherketone	7	Gland	316	ASTM A182 Gr. F316
3	Ball	316	ASTM A182 Gr. F316	8	Gland Flange	316	ASTM A182 Gr. F316
3c	Anti Static Device	316	AISI 316	13	Gasket	SWG	Graphite + 316
4	Stem	316	ASTM A182 Gr. F316	14	Bolt	B8M	ASTM A193 Gr. B8M
4b	Washer	PTFE	Polytetrafluoroethylene	15	Nut	8M	ASTM A194 Gr. 8M
				17	Lever	CS	Carbon Steel + PVC

Figure: E615

Class: 150

STANDARDS

Design	API 608 & ISO 17292 & API 6D
Test	API 598
End to End	ANSI B16.5 RF
End Connection	ANSI B16.10

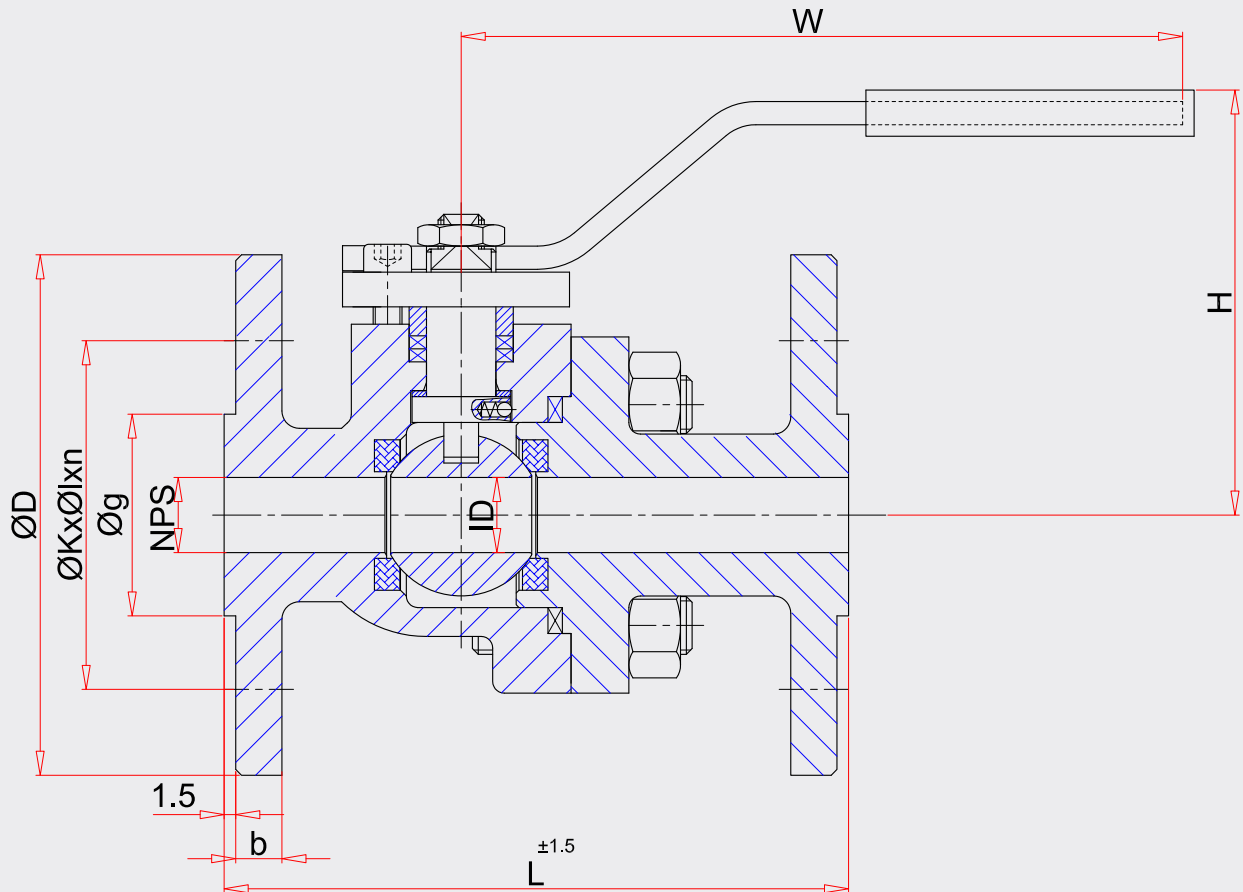

Test Pressure

Class	Shell	Closure
150	30 Barg	22 Barg

Working Pressure (for group 1.1 materials)

-29 +38°C	+100°C Max
19.6 Barg	17.7 Barg

Dimensions & Weight

NPS	ID	ØD	ØK	Øl	n	Øg	b	L	H	W	Weight
inch	mm	mm	mm	mm	mm	mm	mm	mm	mm	mm	kg
1/2	13	89	60.5	16	4	35.1	7.9	108	75	160	2
3/4	20	99	69.8	16	4	42.9	8.6	117	80	160	2.6
1	25	108	79.2	16	4	50.8	9.7	127	99	190	3.8
1 1/2	38	127	98.6	16	4	73	12.7	165	117	260	7.3
2	49	152	120.7	19	4	91.9	14.2	178	138	300	12

All dimensions are in millimeters.

Figure: E625

Class: 300

STANDARDS	
Design	API 608 & ISO 17292 & API 6D
Test	API 598
End to End	ANSI B16.5 RF
End Connection	ANSI B16.10

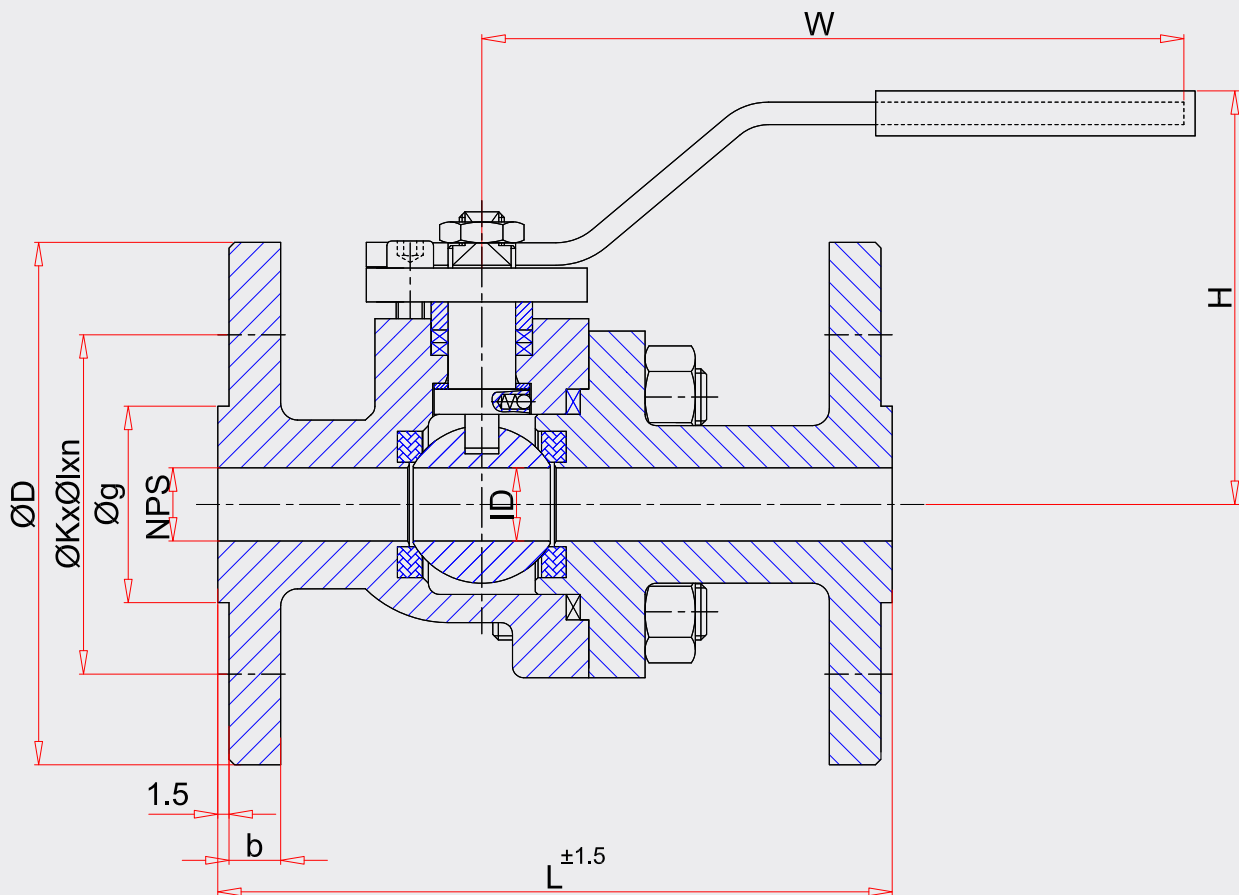

Test Pressure

Class	Shell	Closure
300	77 Barg	57 Barg

Working Pressure (for group 1.1 materials)

-29 +38°C	+100°C Max
51.1 Barg	46.6 Barg

Dimensions & Weight

NPS	ID	ØD	ØK	ØI	n	Øg	b	L	H	W	Weight
inch	mm	mm	mm	mm	mm	mm	mm	mm	mm	mm	kg
1/2	13	95	66.5	16	4	35.1	12.7	140	75	160	2.6
3/4	20	117	82.6	19	4	42.9	14.2	152	80	160	3.9
1	25	124	88.9	19	4	50.8	15.7	165	99	190	5.3
1 1/2	38	155	114.3	22	4	73	19	190	117	260	10.4
2	49	152	127	19	8	91.9	20.6	216	138	300	15

All dimensions are in millimeters.

Figure: E635

Class: 600

STANDARDS

Design	API 608 & ISO 17292 & API 6D
Test	API 598
End to End	ANSI B16.5 RF
End Connection	ANSI B16.10

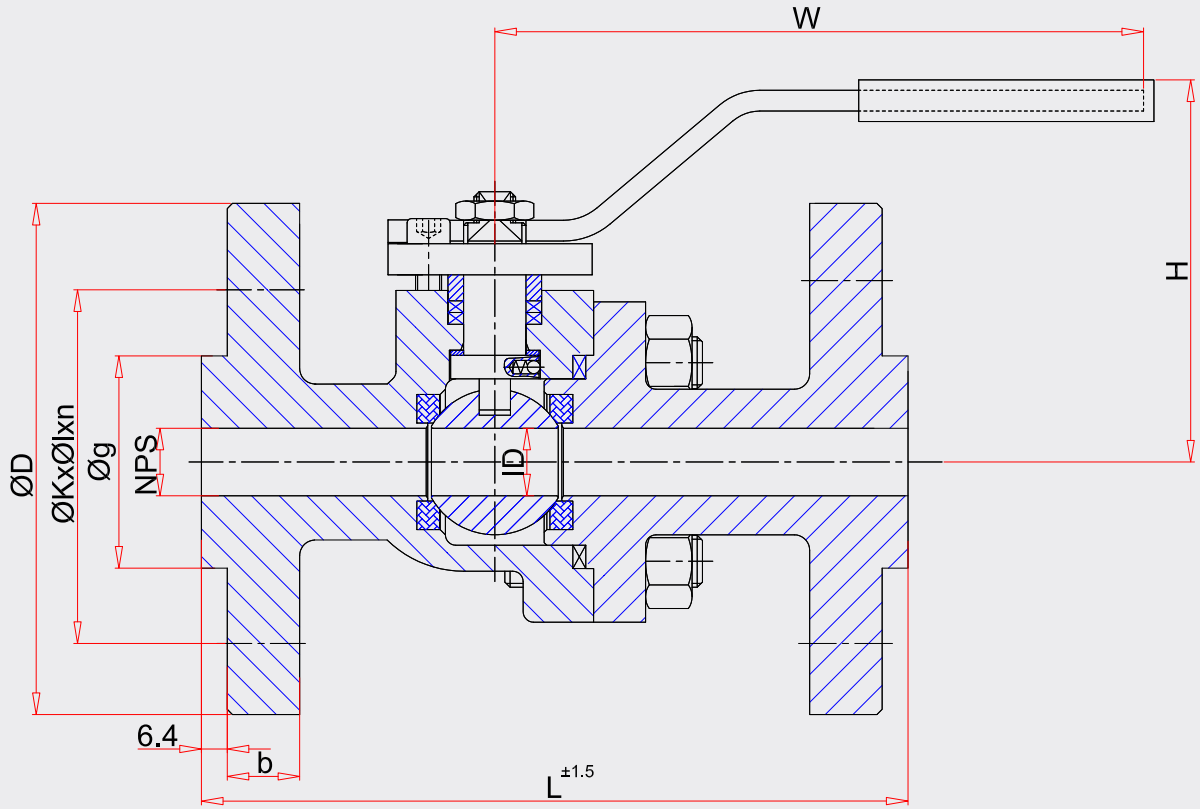

Test Pressure

Class	Shell	Closure
600	154 Barg	80 Barg

Working Pressure (for group 1.1 materials)

-29 +38°C	+100°C Max
102.1 Barg	93.2 Barg

Dimensions & Weight

NPS	ID	ØD	ØK	Øl	n	Øg	b	L	H	W	Weight
inch	mm	mm	mm	mm	mm	mm	mm	mm	mm	mm	kg
1/2	13	95	66.5	16	4	35.1	14.2	165	75	160	3
3/4	20	117	82.6	19	4	42.9	15.7	190	80	160	4.4
1	25	124	88.6	19	4	50.8	17.5	216	99	190	5.8
1 1/2	38	155	114.3	22	4	73	22.4	241	117	260	11.7
2	49	165	127	19	8	91.9	25.4	292	138	300	17.5

All dimensions are in millimeters.

Figure: E645&E655

Class: 900&1500

STANDARDS

Design	API 608 & ISO 17292 & API 6D
Test	API 598
End to End	ANSI B16.5 RF
End Connection	ANSI B16.10

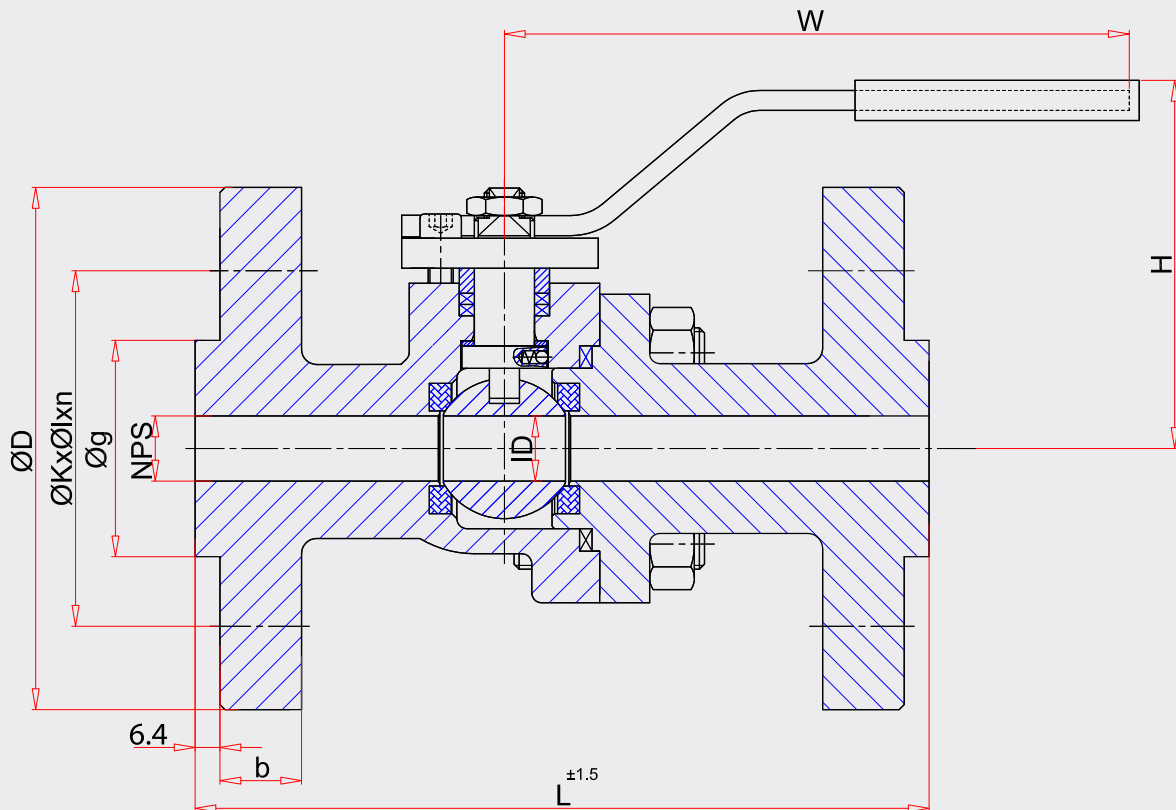

Test Pressure

Class	Shell	Closure
900	230 Barg	80 Barg
1500	383 Barg	80 Barg

Working Pressure (for group 1.1 materials)

-29 +38 °C	+100 °C Max
153.2 Barg	139.8 Barg
255.3 Barg	233 Barg

Dimensions & Weight

NPS	ID	ØD	ØK	Øl	n	b	Øg	L	H	W	Weight
inch	mm	mm	mm	mm	mm	mm	mm	mm	mm	mm	kg
1/2	13	121	82.6	22	4	22.4	35.1	216	75	160	3.75
3/4	20	130	88.9	22	4	25.4	42.9	229	80	160	5.5
1	25	149	101.6	25	4	28.4	50.8	254	99	190	7.25
1 1/2	38	178	124	29	4	31.8	73	305	117	260	14.6
2	49	216	165.1	25	8	38.1	91.9	368	138	300	21.8

All dimensions are in milimeters.

REFERENCE PROJECTS, E605



BOTAS RMS-A	BOTAS	RMS Regulating Metering Station	Turkey	1"	2015
Domestic Gas Distribution Projects	Bulgartransgaz	Natural Gas Transportation	Bulgaria	1/2"-1"	2016
GEX 1300 - 12MW Geothermal Power Plant	Greeneco	Geothermal Water	Turkey	1/2"-2"	2016
Ville De Benguerir Green Energy Park 1MWe CSP-ORC Pilot Plant	Exergy Spa	Solar Power Plant	Italy	1"	2016
TANAP	TANAP	Natural Gas Transportation	Turkey	1/2"-2"	2016
Tupras Refinery	Tupras	Crude Oil Refining	Turkey	1/2"-2"	2016
Domestic Gas Distribution Projects	Fluxys	Natural Gas Transportation	Belgium	1/2"	2017
IGA Airport	IGA	Jet Fuel Tank Farm	Turkey	1/2"-2"	2017
OPET Korfez Terminal	OPET	Bulk Fuel Storage	Turkey	2"	2018
Falcon	STEG	Natural Gas Distribution	Tunisia	2"	2019

E605 REFERENCE, CLIENT LIST

- End User
 - Aksagaz, Turkey
 - Arab Potash, Jordan
 - Bangladesh Government, Bangladesh
 - Baskentgaz, Turkey
 - Beygaz, Turkey
 - BOTAS, Turkey
 - Bulgartransgaz, Bulgaria
- Bursagaz, Turkey
 - Cengiz Holding, Turkey
 - Dogugaz, Turkey
 - Dragon Oil, Turkmenistan
 - Efeler Jeothermal, Turkey
 - Enerjeo Kemaliye, Turkey
 - Exergy Spa, Italy
 - Fetgaz, Turkey
- Fluxys, Belgium
 - Forain Gaz, Bangladesh
 - Gama, Turkey
 - Gemsat, Turkey
 - Gips, Turkey
 - Greeneco, Turkey
 - Hellenic Gas Transmission System Operator (DESFA S.A.), Greece



Important Valves in 2019 according to request 107 CK (CK.41)	Petro Vietnam Gas.	Other	Vietnam	1/2"-1"	2019
Materials and Pipe Line Construction RPCL, Bangladesh Government	Bangladesh Government	Natural Gas Transportation	Bangladesh	1/2"-2"	2019
Perenco Diyarbakir	Perenco	Crude Oil Refining	Turkey	2"	2019
Qaz Ihrac	SOCAR	Natural Gas Transportation	Georgia	1/2"-1"	2019
Turk Akimi	Fetgaz	RMS Regulating Metering Station	Turkey	2"	2019
Amman Strategic Reserve Terminal for Petroleum Products	Jordan Oil Terminals Company	Crude Oil Terminal	Jordan	3/4"-2"	2020
LAM-A,B,C & 28 Platforms New Field Instrumentation	Dragon Oil PLC	Pipeline	Turkmenistan	2"x1"-2"	2020
Jasa Perancangan, Pengadaan Dan Konstruksi (EPC) Pembangunan Pipa Gas Kuala Tanjung - Sumatra Utara	PT Pertamina Gas	Pipeline	Indonesia	2"	2020
Onesti	Transgaz	Natural Gas Measure & Compression	Romania	1/2"-2"	2020

- IGA, Turkey
- Izmirgaz, Turkey
- Jordan Oil Terminals Company, Jordan
- Karadeniz Holding, Turkey
- Kirgiz Dogalgaz, Turkey
- Limak Energy, Turkey
- MECI, France
- NATO, Belgium

- OPET, Turkey
- Palmet, Turkey
- Perenco, Turkey
- Petro Vietnam Gas., Vietnam
- PT Pertamina Gas, Indonesia
- SEWA, Dubai
- SOCAR, Georgia
- STEG, Tunisia

- Sui Southern Gas Company Limited(SSGC), Pakistan
- TANAP, Turkey
- TPAO, Turkey
- Transgaz, Romania
- TROYA, Turkey
- Tupras, Turkey

PRODUCT RANGE

Main Product Range are Ball Valves, Gate Valves, Check Valves, Globe Valves, Plug Valves, Hydraulic Actuators & Pneumatic Actuators.

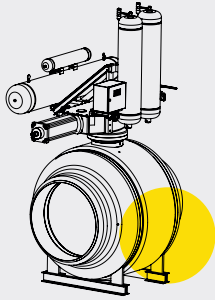

FULL WELDED BALL VALVES

API 6D monogrammed
Safety Integrity Level (SIL) Certified,
ATEX, PED

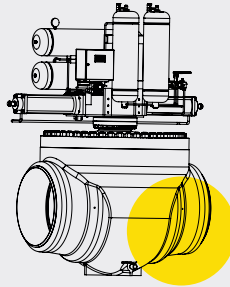

TOP ENTRY BALL VALVE

API 6D monogrammed
Safety Integrity Level (SIL) Certified,
ATEX, PED

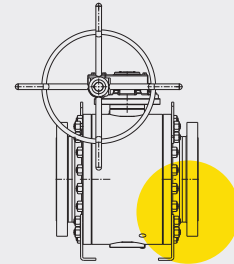

SPLIT BODY BALL VALVES

API 6D monogrammed
Safety Integrity Level (SIL) Certified,
ATEX, PED

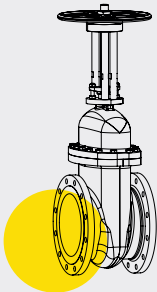

WEDGE GATE VALVES

API 600 monogrammed
Safety Integrity Level (SIL) Certified,
ATEX, PED

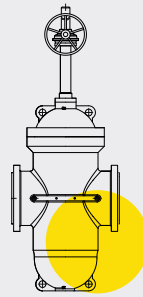

CONDUIT GATE VALVES

API 6D monogrammed
Safety Integrity Level (SIL) Certified,
ATEX, PED

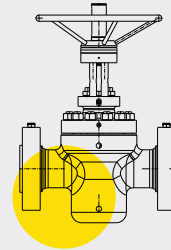

API 6A GATE VALVES

API 6A monogrammed
Safety Integrity Level (SIL) Certified,
ATEX, PED

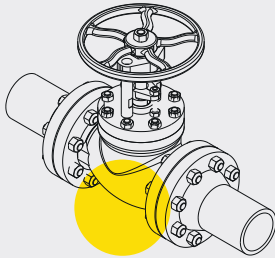

GLOBE VALVES

BS 1873 / API 623
Safety Integrity Level (SIL) Certified,
ATEX, PED

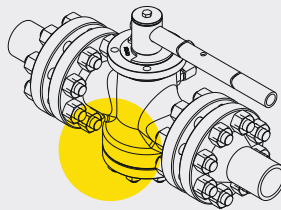

PLUG VALVES

API 6D monogrammed
ATEX, PED

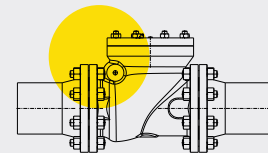

CHECK VALVES

API 6D monogrammed
ATEX, PED

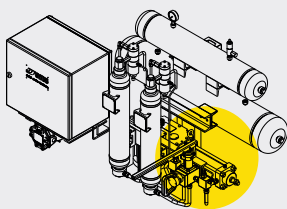

HYDRAULIC & PNEUMATIC ACTUATORS

ASME U-Stamp, Safety Integrity
Level (SIL) Certified, ATEX, PED

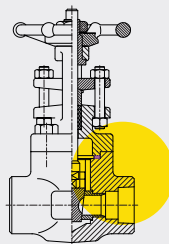

COMPACT FORGED VALVES

API 6D / API 602 / API 608/ BS 5352
/ISO 17292
Safety Integrity Level (SIL) Certified,
(E604 & E60T)

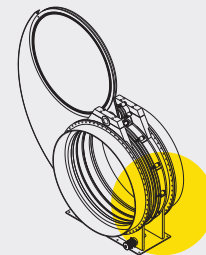

TAILOR MADE

As a designing and manufacturing
company we are not limited with the
product range, we offer tailor made
valve and actuator solutions as well.



VASTAŞ VALF ARMATÖR SANAYİ TİCARET A.Ş.

Manufacturing Plant & Office

Organize Sanayi Bölgesi 2. Cad. No:22

Cerkezkoy 59500

Tekirdağ — Turkey

T:+90 282 758 36 50

F:+90 282 758 36 59

www.vastas.com

Istanbul Office

Perpa Ticaret Merkezi, Kat-13, A-1977

Okmeydani, Sisli 34384

Istanbul — Turkey

T: +90 212 221 39 81

F: +90 212 222 63 59